

ROCKINGHAM

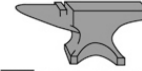

FORGE

A range of knife sharpeners for
the home and professional kitchen

GUARANTEE

As always, quality and durability are standard features of the Grunweg name and this product is fully guaranteed against defects arising from faulty materials or workmanship.

This guarantee is in addition to your statutory rights.

This range of products was manufactured in China for I. Grunweg Ltd.

Unauthorised reproduction of these products or their packaging is strictly prohibited.



GRUNWEG
SHEFFIELD • ENGLAND

29-49 Rockingham Street
Sheffield S1 4EA

Telephone: +44 (0)114 275 6700

Fax: +44 (0)114 276 0810

Email: sales@grunweg.co.uk

www.grunweg.co.uk



GRUNWEG
SHEFFIELD • ENGLAND



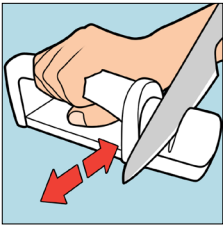

CS-110BK Single-wheel Ceramic Sharpener

MS-007DC 2-wheel Diamond & Ceramic Sharpener

MS-009DC 2-wheel Diamond & Ceramic Sharpener

ES-103DD Electric Diamond Sharpener

103D/SP Spare Grinding Unit for ES-103DD



PULL-THROUGH SHARPENERS

- Ceramic and diamond wheels for fine and super-fine sharpening
- Easy-to-use forwards and backwards motion
- Spare wheels available

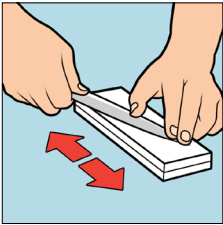

CW-851CM Combination Whetstone (240/8000)

CW-961MF Combination Whetstone (1000/3000)

CW-914MF Combination Whetstone (3000/8000)

DW-831D Combination Whetstone (360/600)



WHETSTONES

- The professional way to keep knives sharp
- Easy to use
- Guide rails available
- Available in 4 finishes: rough, medium, fine and super-fine
- Available as combination stones
- Holder provided

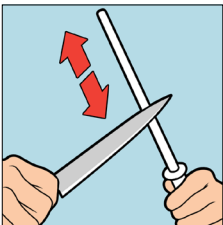

CS-846C/10 10inch Ceramic 'Steel'

CS-847C/12 12inch Ceramic 'Steel'

DS-825D/10 10inch Diamond 'Steel'

DS-826D/12 10inch Diamond 'Steel'

CS-16265C 10.5inch Ceramic 'Steel'

CS-1627OS 11inch Ceramic 'Steel'



SHARPENING 'STEELS'

- The traditional way of sharpening
- Available in ceramic or diamond
- Ergonomically-designed handle
- Available in various sizes

